



**HARRY REID**  
**INTERNATIONAL**  
**LAS VEGAS**



# Modernization Plan for Harry Reid International Airport

Supporting the Clark County Airport System Transformation

Clark County Board of County Commissioners  
October 1, 2024

---

# Contents

**section 1**  
Harry Reid International Airport

**section 2**  
Supplemental Airport

**section 3**  
Next Steps



**1**

**Harry Reid Int'l Airport**



## Maximizing Harry Reid International Airport

Our goal is to ensure that Harry Reid International Airport (LAS) remains the centerpiece of our large hub commercial airport and combined with the supplemental airport, will become the Flagship of our entire airport system. The reimagined campus will enhance guest experience and more efficiently maximize airport operations with improved ways to connect people to the region. Safe and convenient multimodal centers will accommodate visitors and the local communities throughout the valley.



# Recent Upgrades

---

## Customer-Facing Improvements

Just the past year, we have made many improvements in the terminals, from modernizing the remaining 60% of the hold rooms in the D Gates to adding more food, beverage, and retail options across all concourses to enhance the guest experience.

# NEW D CONOURSE

## FLIGHT INFORMATION DISPLAY SYSTEM



# UPGRADE D-GATE HOLD ROOMS



New Podiums



New In-seat Charging

# NEW CLUB LOUNGE





# VEGAS BORN BAR



# CHILI'S BAR



# NEW RETAIL



# KONA BAR



# MODELO BAR



Coming Soon....

ADDITION  
AT A GATES

Building  
Additions at A  
and C Gates

ADDITION  
AT C GATES



# NEW TERMINAL 1

# BUILDING ADDITION AT GATES A

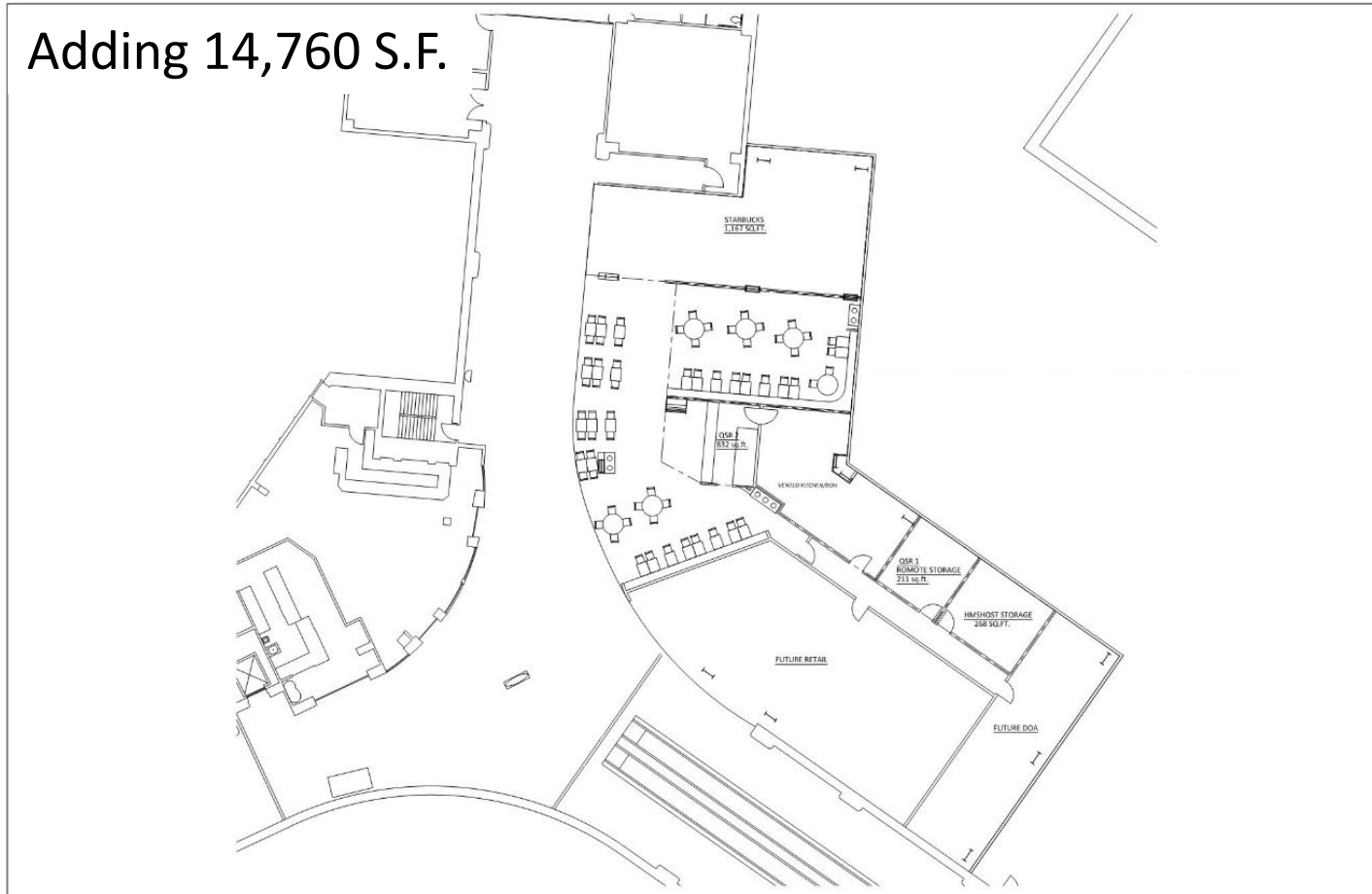

Coming Soon....



# NEW TERMINAL 1 BUILDING ADDITION AT GATES C

Adding 31,928 S.F.

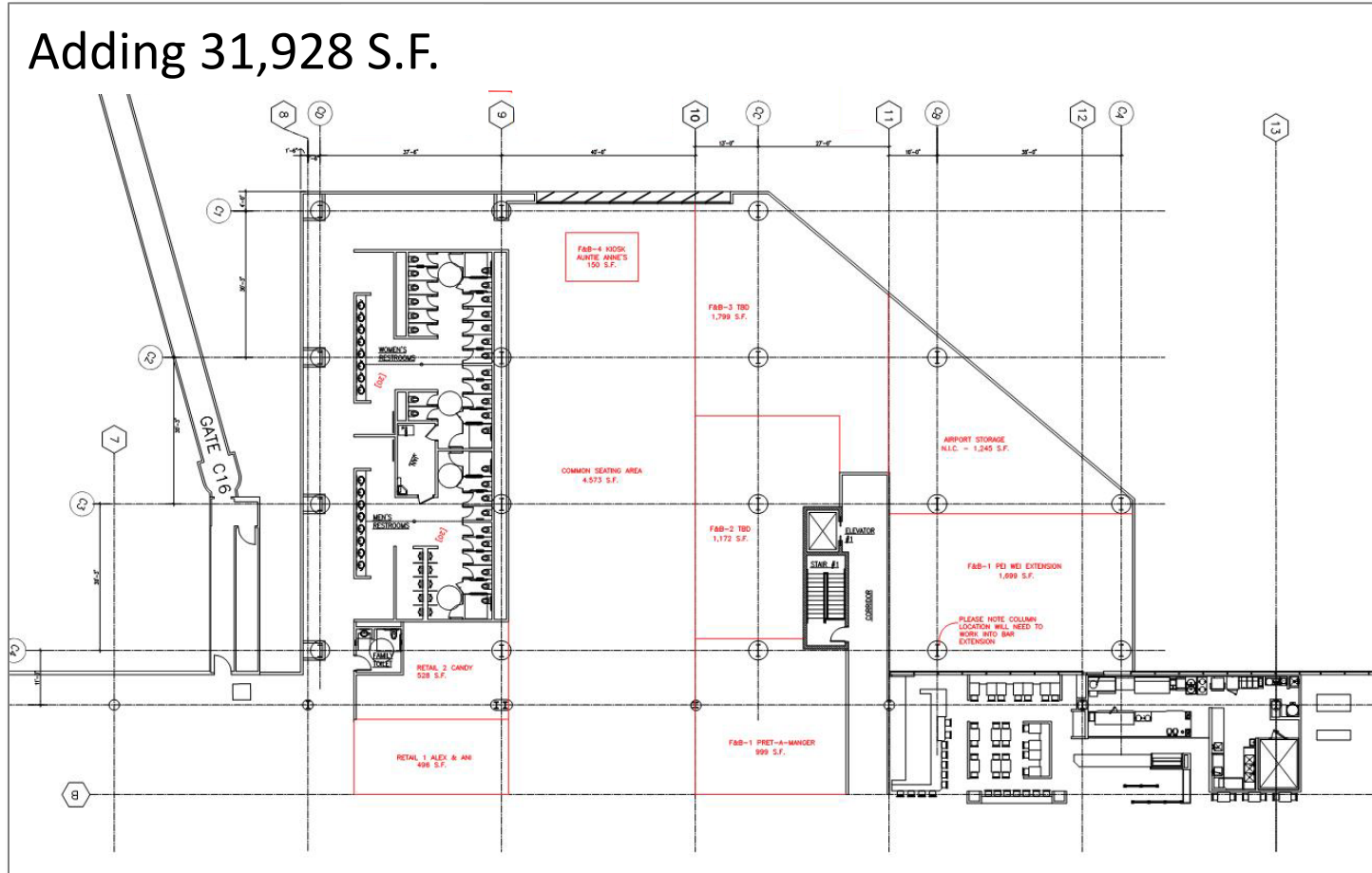

Coming Soon....



# NEW CENTRAL WAREHOUSE



Coming Soon....





# Maximize Terminal 1

---

## Terminal 1 Modernization

The modernization plan calls for expanding Terminal 1 on the old Terminal 2 site. It also calls for demolishing all the existing Terminal 1 cluster building concourses and replacing them with a new pier-design concept.

The new design will offer more gates, large hold rooms with high ceilings. All concourses are accessible to our guests and outfitted with the latest wayfinding and technology, as well as other essential amenities.

# Maximization

TERMINAL 1  
TODAY

The existing layout of Terminal 1 utilize 39 outdated and inefficient gates, given how our airlines operate today.

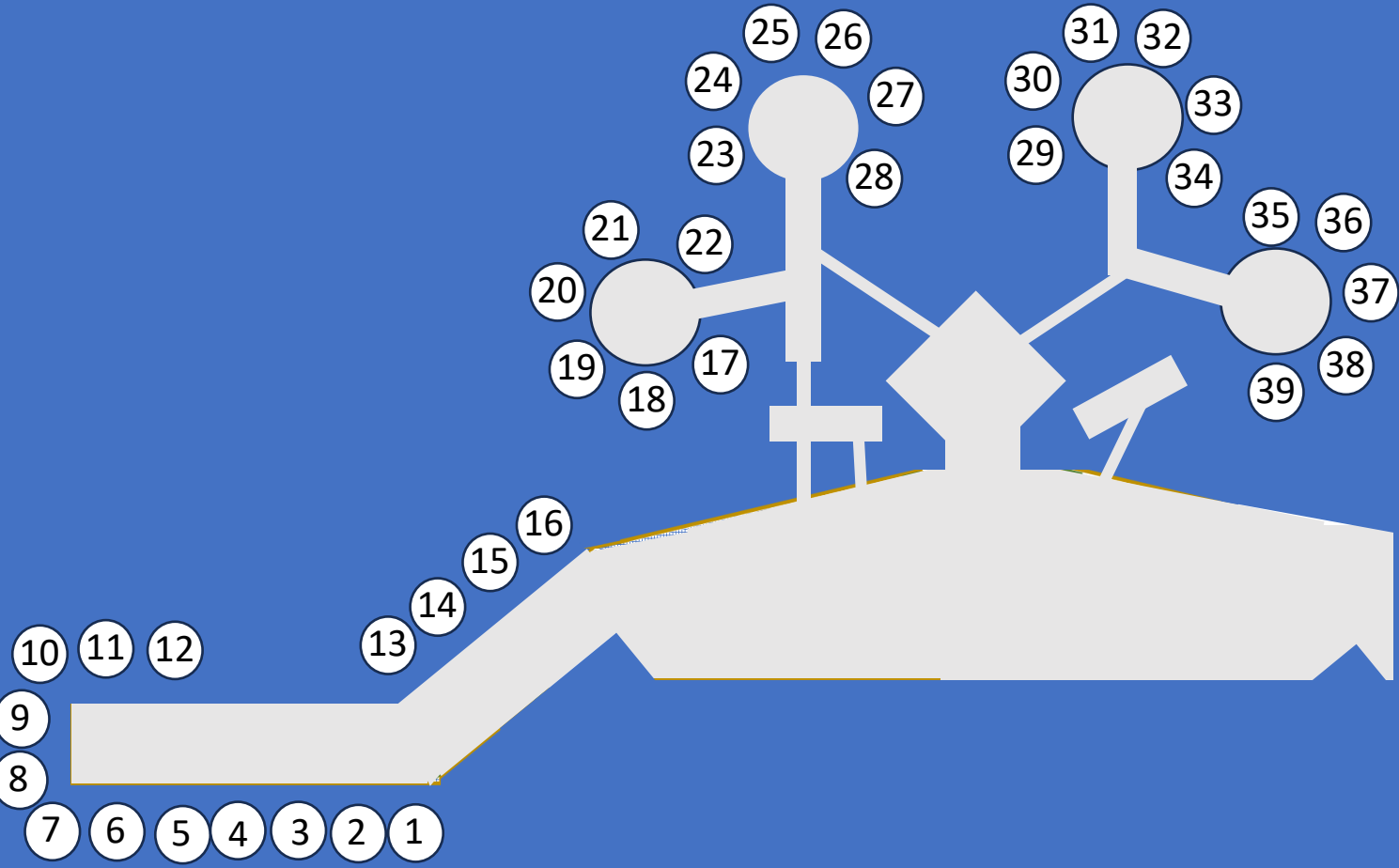

# Maximization

# TERMINAL 1 MODERNIZATION FUTURE

The proposed facility will enhance guest experience; adding 26 new gates that are more efficient and functional.

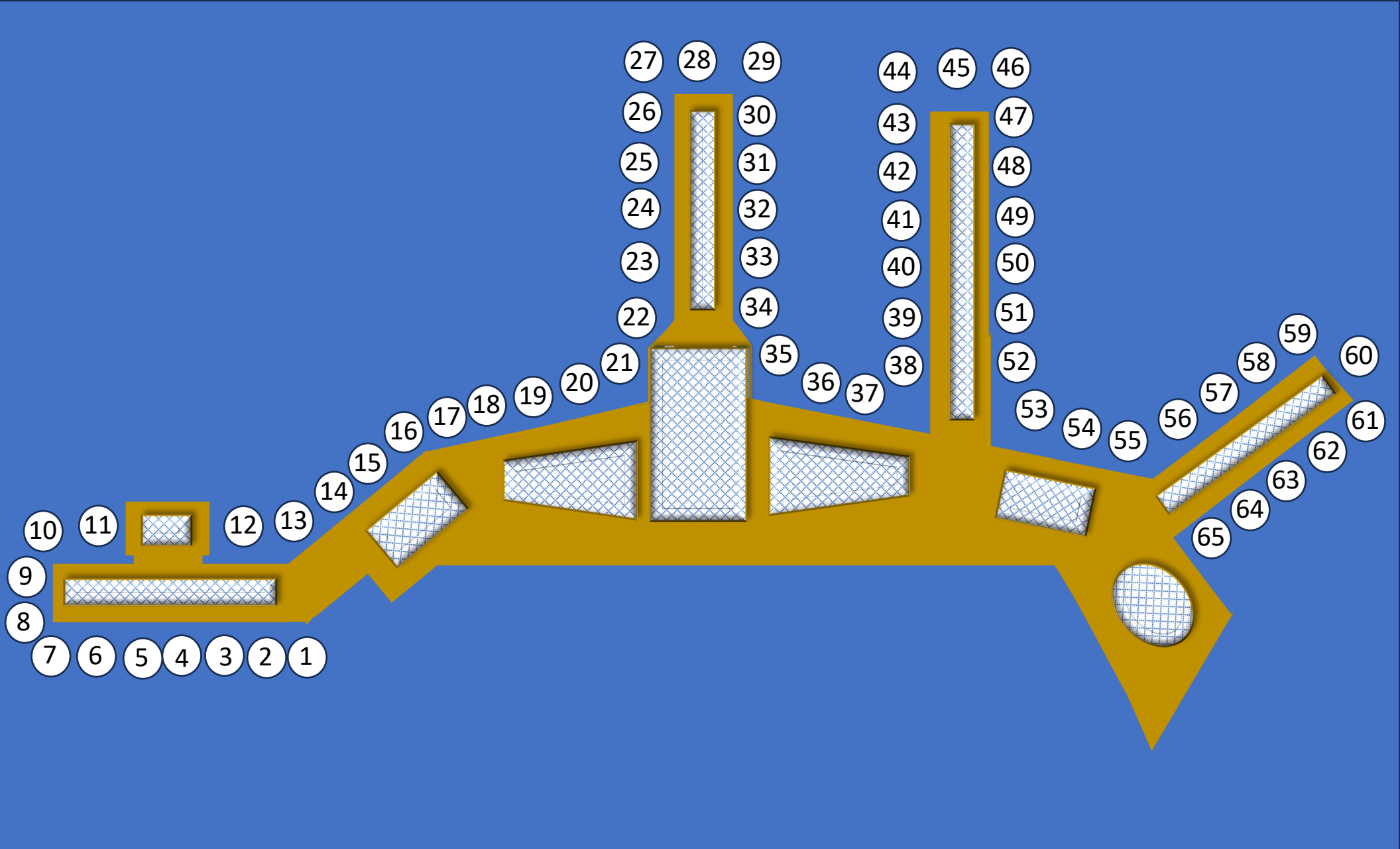

**Maximize**  
**Terminal 2**

—  
**Balance Terminal 2 (aka Terminal 3)**

Maximizing Harry Reid International Airport (LAS) will require the full capability of both terminals. Balancing carriers to consolidate operations at the “new” designated Terminal 2 (aka, Terminal 3) will reduce congestion at Terminal 1, simplify wayfinding, and improve guest experience.

# Maximization

TERMINAL 2 (aka T3)  
TODAY

We are proposing to reimagine Level 2 curbside, ticketing, baggage handling, and passenger circulation.

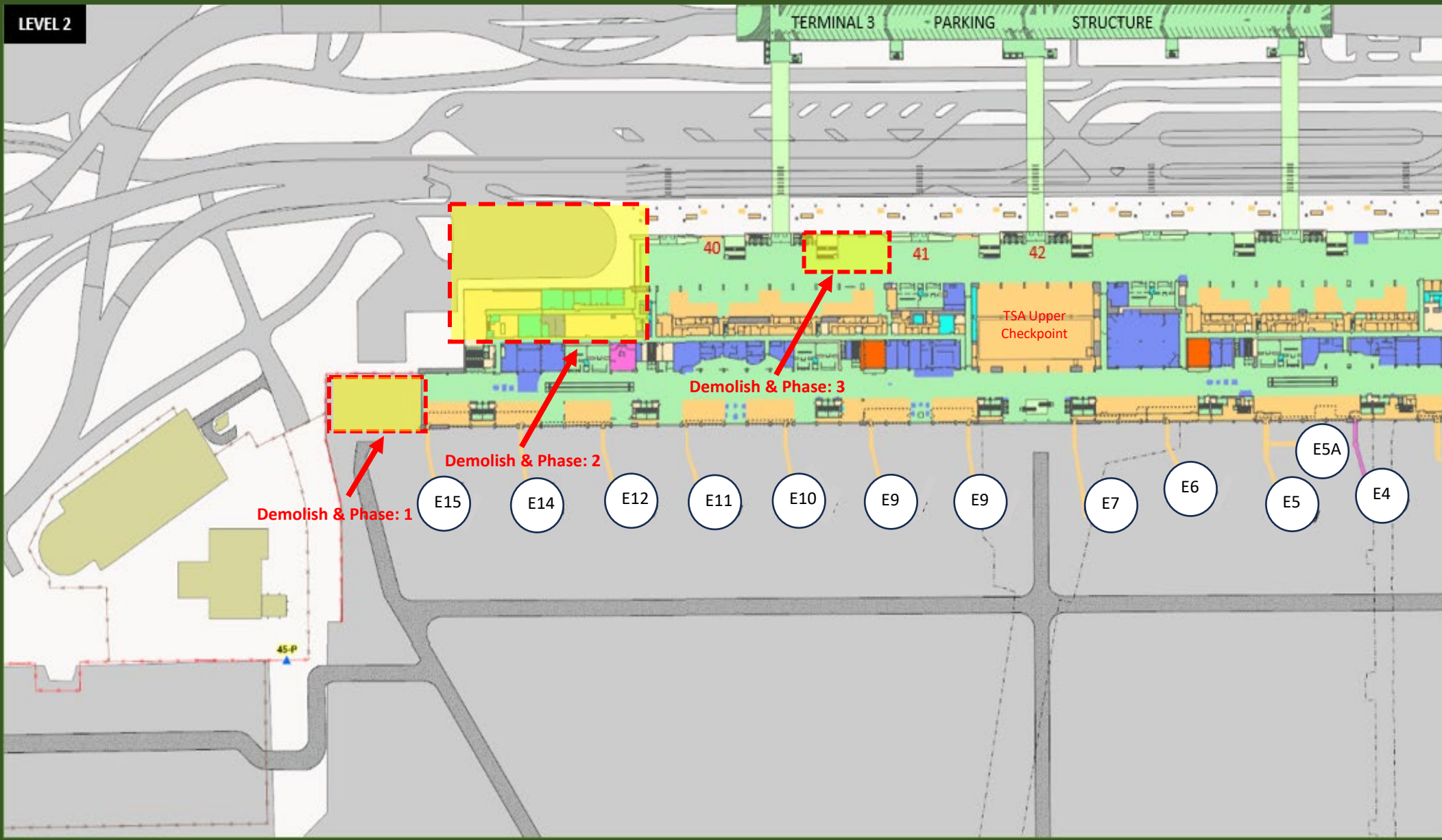

# Maximization

TERMINAL 2 (aka T3)  
FUTURE

The new expansion will balance guest ticketing process, increase security checkpoint rate, and reduce curbside congestion.

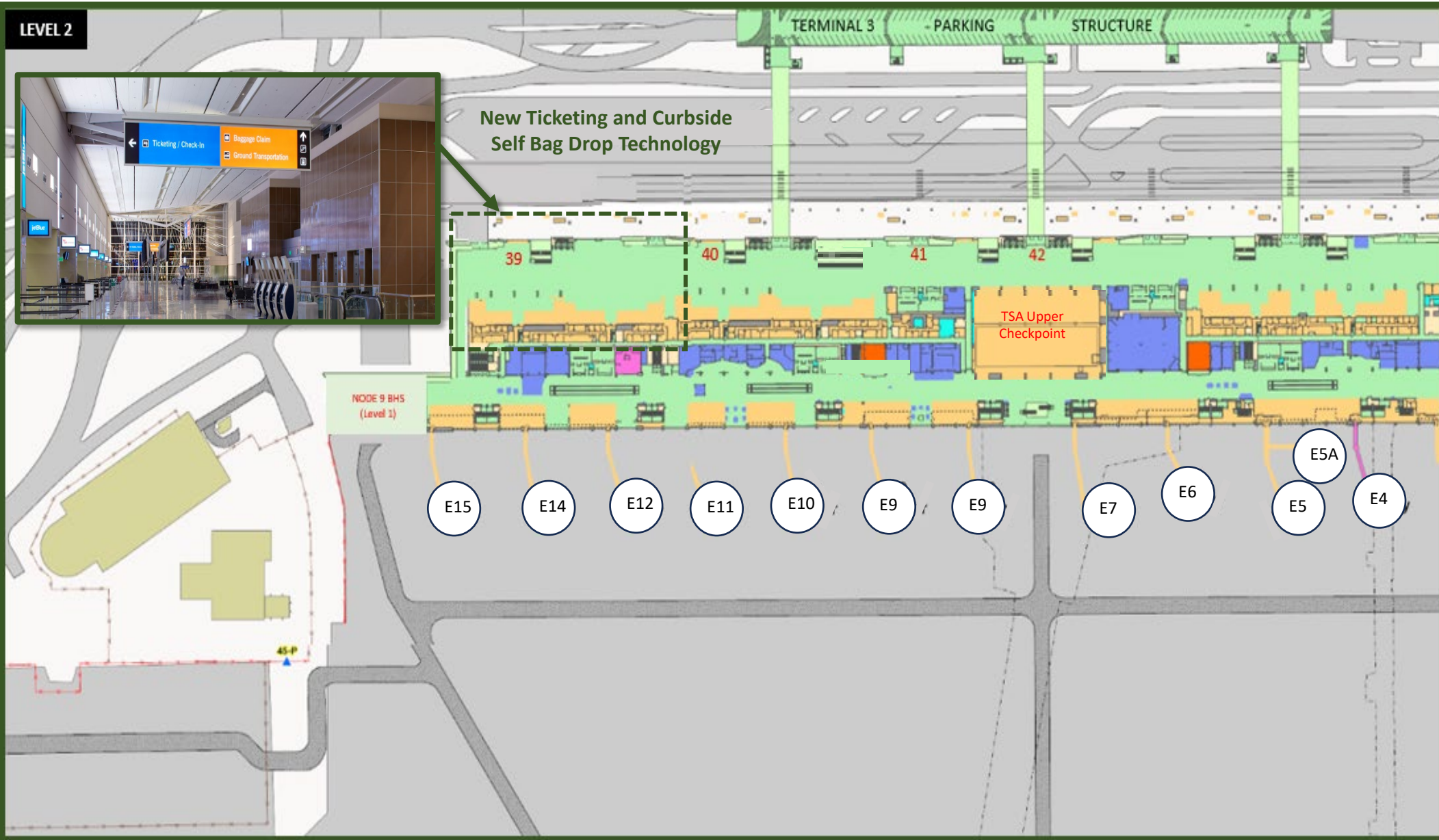

# Maximization

TERMINAL 2 (aka T3)  
FUTURE

The new express escalators will direct guest from Level 2 ticketing to Level 0 Security Checkpoint and D-Gates seamlessly.

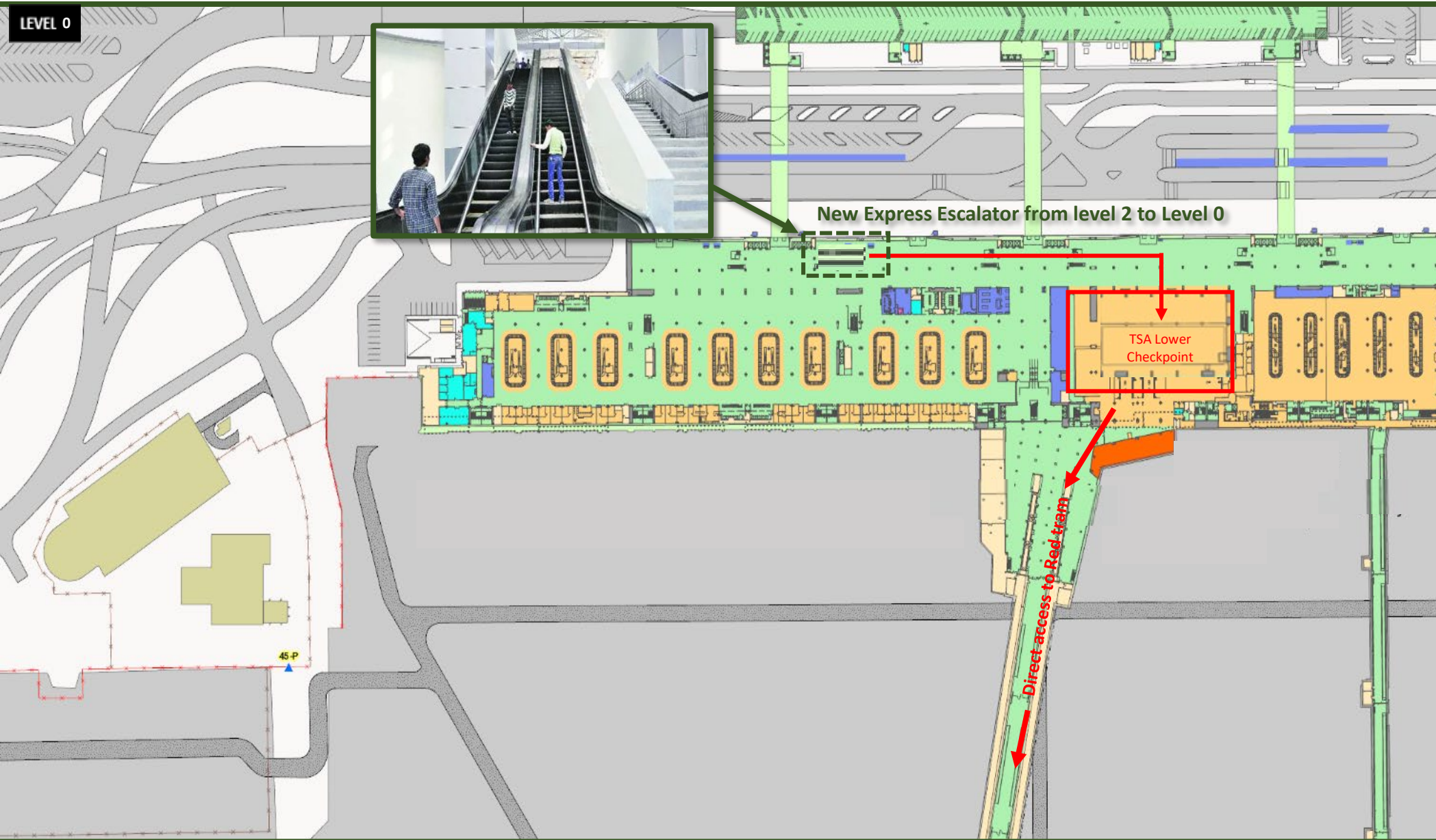

---

## LAS Roadway Circulation

Improving the traffic flow and making it more maneuverable will require introducing two near-term projects and one longer-term road in the future. These solutions significantly improve airport vehicular movement and traffic safety and provide bypass commuter traffic separation.

The Planning Team gleaned important factors from earlier roadway infrastructure studies to improve vehicular circulation from Harry Reid International Airport to the north and south multimodal centers.



# Connection

**Roadway 1:** The Terminal-to-Terminal flyover roadways will support the one-way circular motion of airport traffic circulation.

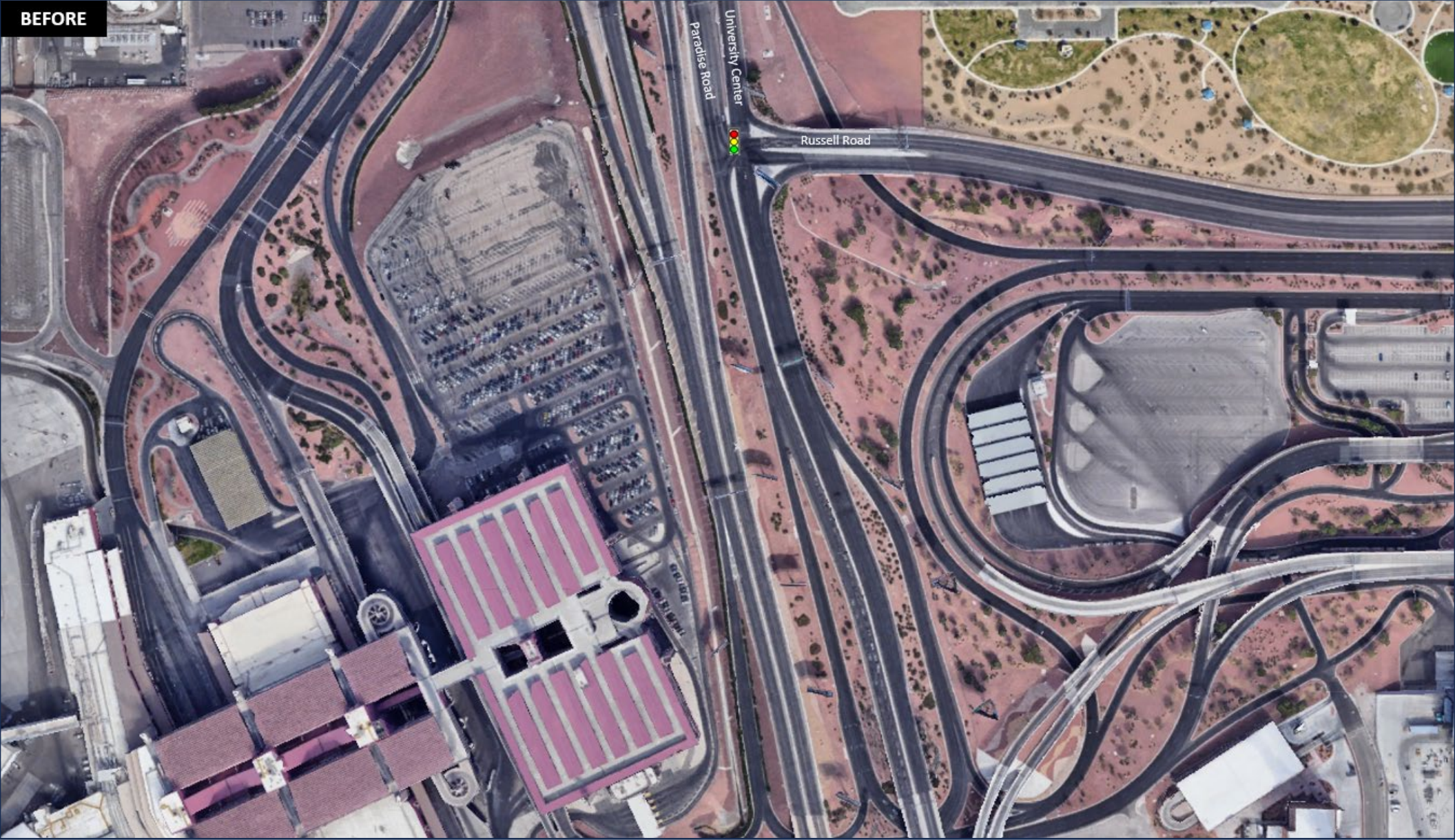

# Connection

**Roadway 1:** The Terminal-to-Terminal flyover roadways will support the one-way circular motion of airport traffic circulation.



# Connection

**Multimodal Centers:** The two multimodal centers will provide access to ride share, public transportation options, and airport crew members and employee parking.

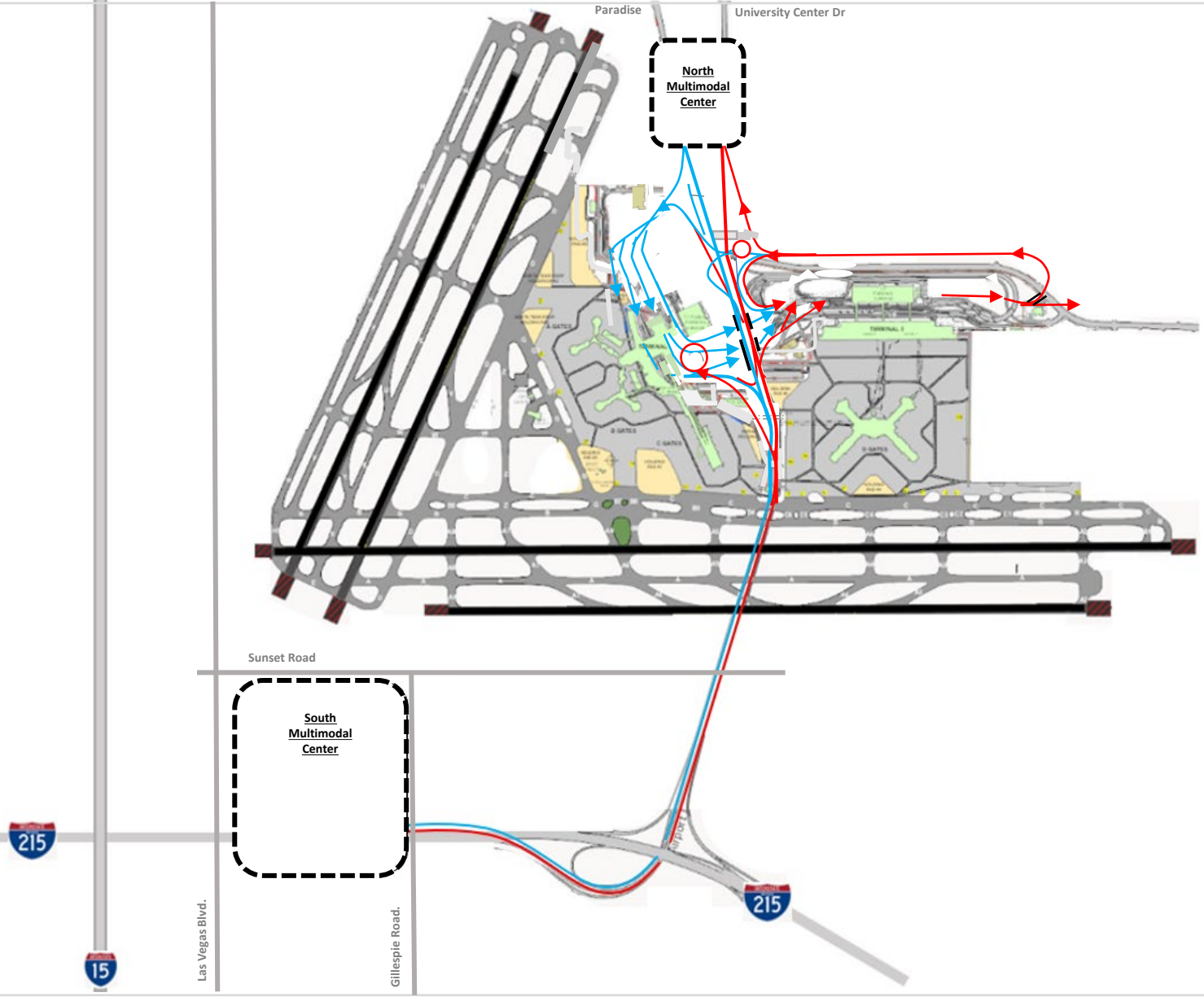

# 2 Supplemental Airport

# Expansion: Southern Nevada Supplemental Airport (SNSA)

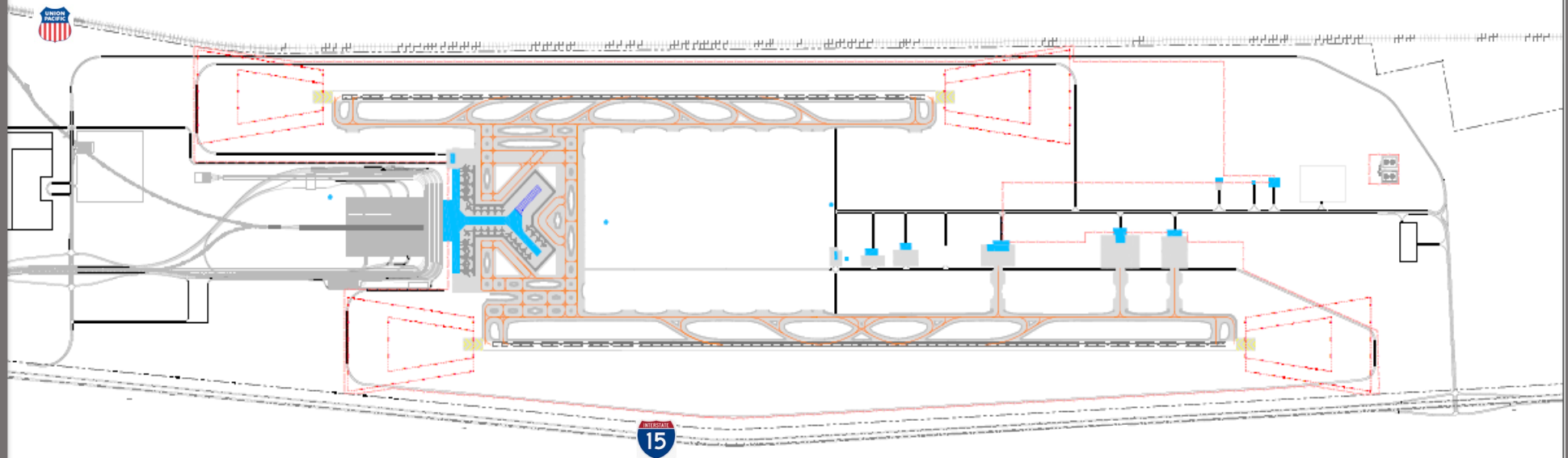

- LEGEND
- Airfield Building
  - Airfield Pavement
  - Reserved for Future Expansion
  - Taxiway/Taxilane Centerline
  - Runway Protection Zone
  - ##### Railroad
  - Security Fence
  - Property Boundary
  - Service Road

The most significant long-range initiative of the Strategic Business Plan is the Environment Impact Statement (EIS) study, which will make way for the new supplemental commercial airport. The new commercial airport will open airspace, roadways, require new terminal buildings and general aviation to accommodate future growth. The new airport will enhance guest experience, making Las Vegas a one-of-a-kind destination globally.

**ALP DRAFT**

# Expand SNSA

## Supplemental Airport EIS Status

### FEASIBILITY

Our research and analytics comprises more than 20 years of study by some of the most esteemed airport planners and design firms to quantify the opening day cost estimates.

### REGULATION

CCDOA continues to protect all airports for safe airspace, compatible land use, and zoning protections under federal, state, and local regulations.

### NOI

The Joint Lead Agencies (JLA); Federal Aviation Administration (FAA) and the Bureau of Land Management (BLM) selected Landrum & Brown (L&B) to conduct the Environment Impact Study (EIS) signaling the criticality of the new commercial airport. The JLA is moving towards issuing the Notice of Intent (NOI).

### ROD

The JLA will oversee L&B through the EIS process culminating with the Record of Decision (ROD) once complete.

Once a favorable ROD is issued; the DOA will proceed with the design and construction phase for the new commercial airport.



**3  
Next Steps**

# In conclusion

- 
- ▼ **LAS Modernization: Planning-design efforts result in an expanded library of shovel-ready projects**
  - ▼ **SNSA: Continue to work with Joint Lead Agencies (JLAs) to complete the EIS process**
  - ▼ **Key Stakeholder Reports: Provide regular updates detailing ongoing progress**





[www.harryreidairport.com](http://www.harryreidairport.com)

[www.snsaproject.info](http://www.snsaproject.info)